



# 503

1 BEDROOM + DEN  
1,526 SQ.FT.  
+ 181 SQ.FT. TERRACE

## Rooms

- 1 Bedroom
- 2 Baths
- Den
- Laundry Room

This generous 1,526 square foot one bedroom, two bathroom residence has stunning views of the Rosedale ravine with floor-to-ceiling windows spanning the home, allowing in copious natural light. Well-proportioned rooms are graciously dispersed, balancing transparency and privacy. A large laundry room, den, and second bathroom contribute to a living space that feels like a house. The master suite features a walk-through closet and spa-like ensuite with a freestanding soaker tub. Eastern facing windows and spacious terrace create seamless indoor and outdoor living.

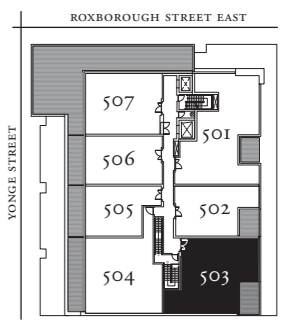

All prices, figures, sizes, specifications and information are subject to change without notice. E.&O.E. All areas and stated dimensions are approximate. Actual usable floor space, living area and square footage may vary from stated floor area. Terrace sizes and locations, if any, vary per floor. All illustrations are artist's concept only.